

West Burton Solar Project

Historic Environment Features Plan Revision A (Tracked)

Prepared by: Lanpro Services

~~March 2023~~ [February 2024](#)

PINS reference: EN010132

Document reference: [APPEX4/WB2.8_A](#)

APFP Regulation 5(2)(m)



Schedule of Changes

<u>Figure Reference</u>	<u>Page</u>	<u>Description of Changes</u>	<u>Reason for Revision</u>
All sheets	3-13	Updates to annotations and title block	For presentational clarity.
Index Sheet	3	Order limits and relevant annotations revised	Change Application
Sheet 1 of 10	4	Extension of Order Limits	Presentation of Order Limit Change 1
Sheet 5 of 10	8	Extension of Order Limits	Presentation of Order Limit Change 2
Sheet 6 of 10	9	Extension of Order Limits	Presentation of Order Limit Change 3
Sheet 7 of 10	10	Extension of Order Limits	Presentation of Order Limit Change 4
Sheet 10 of 10	13	Extension of Order Limits	Presentation of Order Limit Change 5

Key

- Order Limits
- Sheet Index
- County Boundary
- Listed Building**
- Grade I
- Grade II*
- Grade II
- Conservation Area
- Scheduled Monument
- Registered Park and Garden
- Lincolnshire HER (point)**
- Building
- Find Spot
- Monument
- Lincolnshire HER (Line)**
- Building
- Monument
- Lincolnshire HER (poly)**
- Building
- Monument
- Park and Garden
- Nottinghamshire HER (point)**
- Building
- Element
- Find Spot
- Monument
- Nottinghamshire (poly)**
- Building
- Element
- Monument
- Park and Garden

Note: Full details of the Historic Environmental Record (HER) sites and monuments depicted can be found in the gazetteers within the Desk Based Assessment (DBA) which are included in Appendix 13.1 of the Environmental Statement (ES), and the designated assets on Historic England's National Heritage List for England are discussed in detail in the Heritage Statement included in Appendix 13.5 of the ES

Layers: Historic England, 2024; Nottinghamshire County Council, 2024; Lincolnshire County Council, 2024; Lanpro, 2024; ICF, 2024
 Base map: Reproduced from Ordnance Survey digital map data © Crown copyright 2024. All rights reserved. License number 0100031673





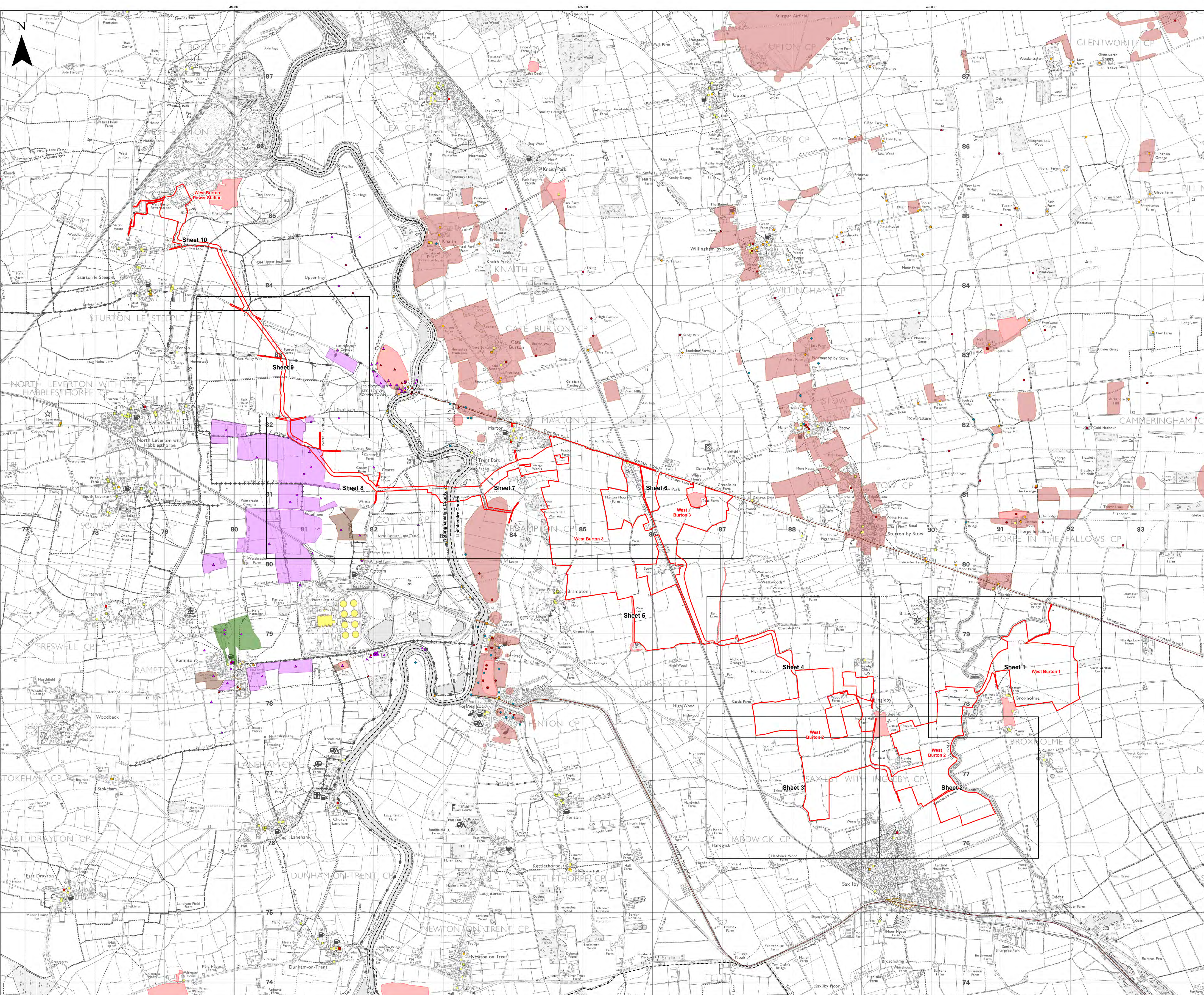

0 1 2 Kilometres
 Scale: 1:17,500@A0

APFP Regulation: 5(2)(m)	Application Doc No. EX4/WB2.8_A
Ref: P2983_LPR_ZZ_ON_DR_Z_0203	Date: 28/02/2024
Drawn by: AZ	Checked by: JC

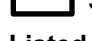
**Plan of Statutory and Non-statutory
 Features of Historic Environment**
 Index Sheet
 Revision A

WEST BURTON SOLAR PROJECT



- Key**
-  Order Limits
 -  Sheet Index
 -  Listed Building
 - Grade**
 -  II
 -  Scheduled Monument
 -  Lincolnshire HER (Line)
 -  Monument
 -  County Boundary

Note:
Full details of the Historic Environmental Record (HER) sites and monuments depicted can be found in the gazetteers within the Desk Based Assessment (DBA) which are included in Appendix 13.1 of the Environmental Statement (ES), and the designated assets on Historic England's National Heritage List for England are discussed in detail in the Heritage Statement included in Appendix 13.5 of the ES

Layers: Historic England, 2024; Nottinghamshire County Council, 2024; Lincolnshire County Council, 2024; Lanpro, 2024; GP, 2024
Base map: Reproduced from Ordnance Survey digital map data © Crown copyright 2024. All rights reserved. License number 0100031673

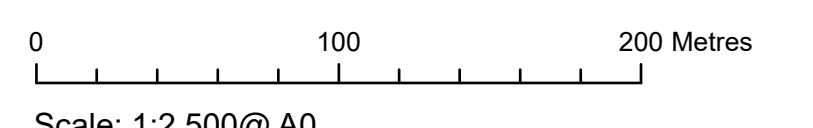

Scale: 1:2,500@A0

APFP Regulation: 5(2)(m)	Application Doc No. EX4/WB2.8_A
Ref: P2963_LPR_ZZ_ON_DR_Z_0204	Date: 28/02/2024
Drawn by: AZ	Checked by: JC

**Plan of Statutory and Non-statutory
Features of Historic Environment**
Sheet 1 of 10
Revision A

WEST BURTON SOLAR PROJECT

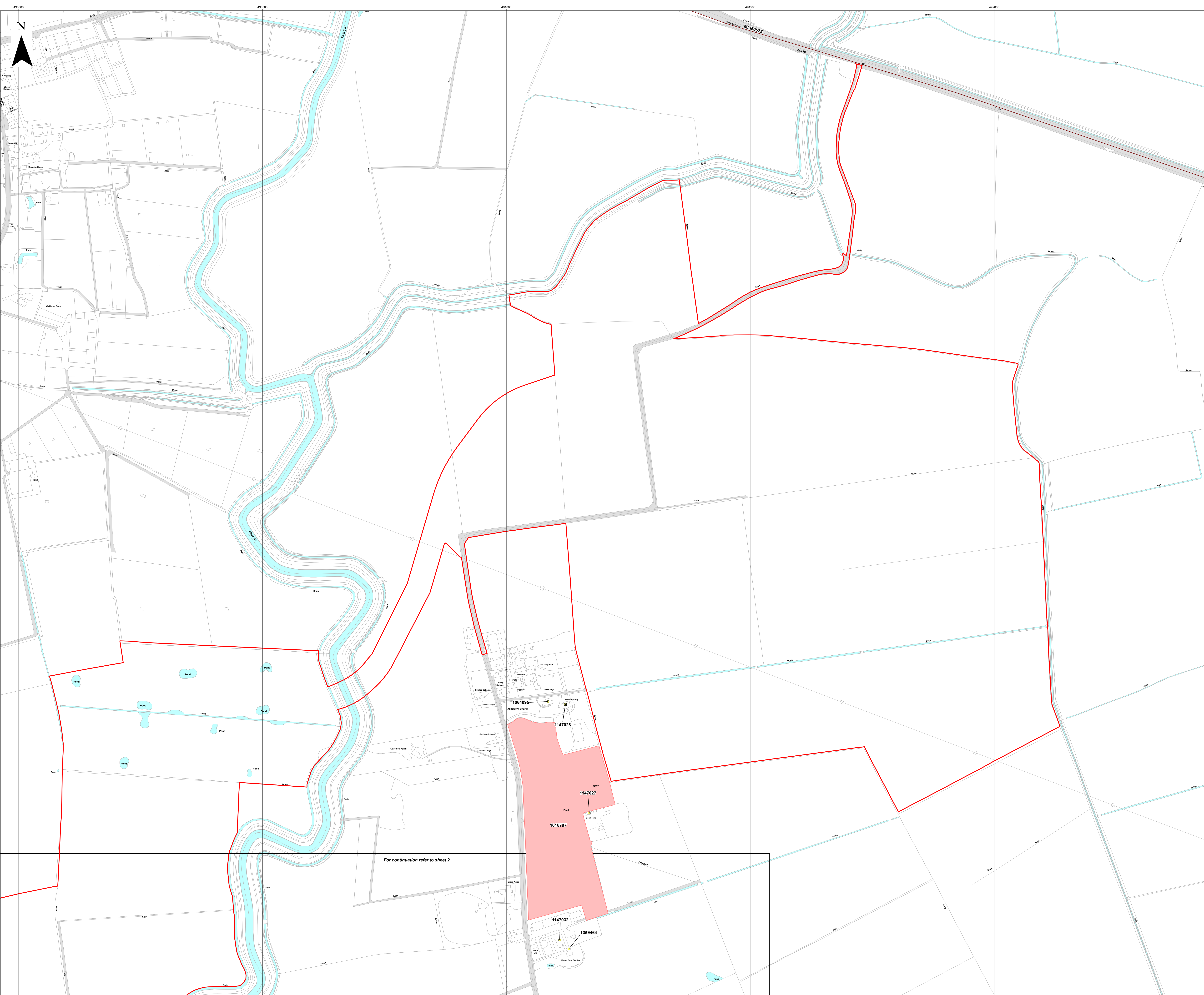

For continuation refer to sheet 2

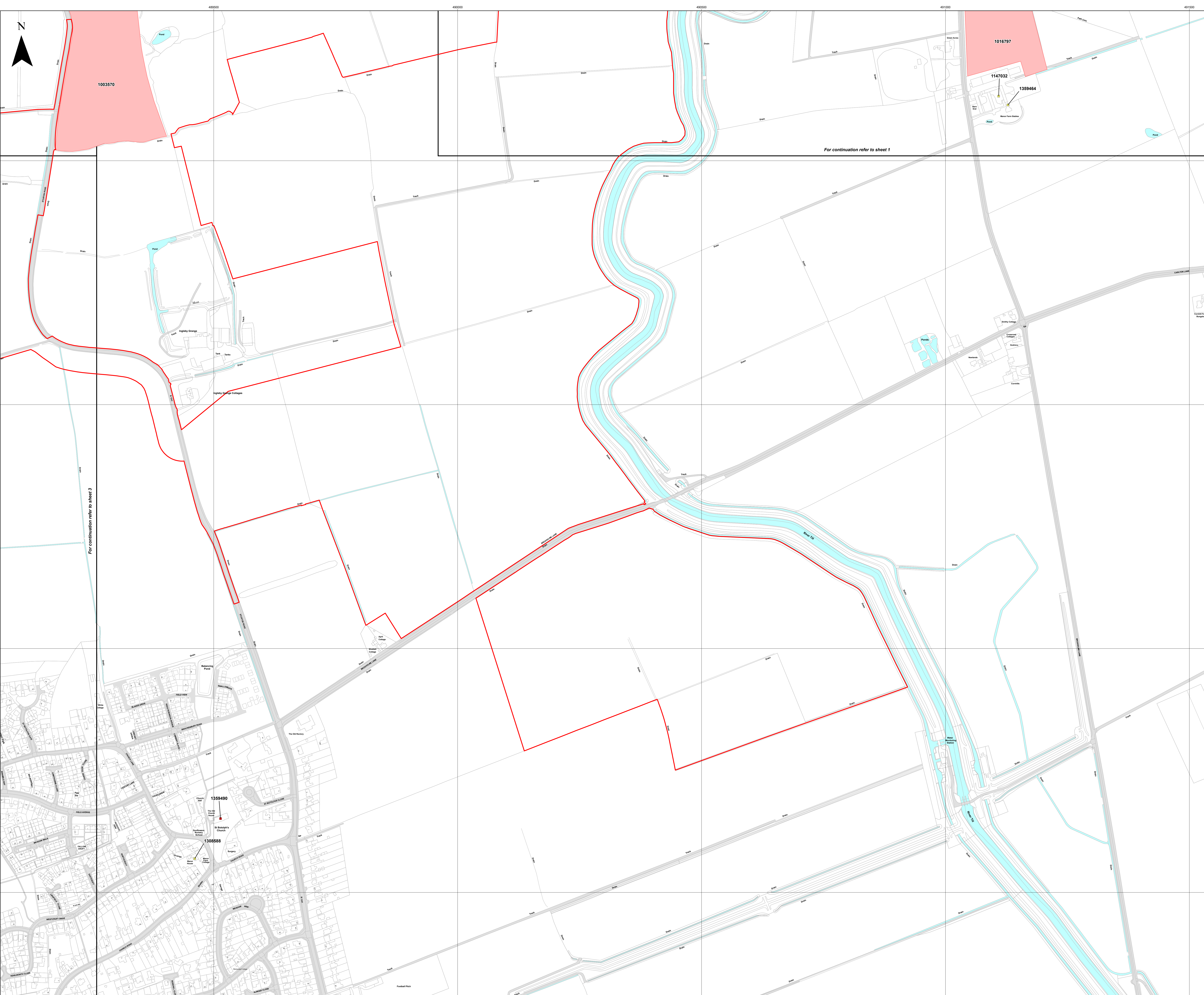

- Key**
- Order Limits
 - Sheet Index
 - Listed Building
 - Grade**
 - I
 - II
 - Scheduled Monument
 - County Boundary

Note:
Full details of the Historic Environmental Record (HER) sites and monuments depicted can be found in the gazetteers within the Desk Based Assessment (DBA) which are included in Appendix 13.1 of the Environmental Statement (ES), and the designated assets on Historic England's National Heritage List for England are discussed in detail in the Heritage Statement included in Appendix 13.5 of the ES

Layers: Historic England, 2016; Nottinghamshire County Council, 2024; Lincolnshire County Council, 2024; Lanpro, 2024; GP, 2024
Base map: Reproduced from Ordnance Survey digital map data © Crown copyright 2024. All rights reserved. License number 0100031673

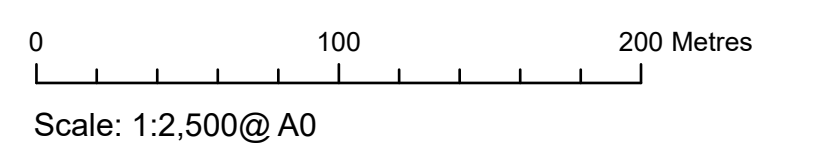

APFP Regulation: 5(2)(m)	Application Doc No. EX4/WB2.8_A
Ref: P2963_LPR_ZZ_ON_DR_Z_0204	Date: 28/02/2024
Drawn by: AZ	Checked by: JC

**Plan of Statutory and Non-statutory
Features of Historic Environment**
Sheet 2 of 10
Revision A

WEST BURTON SOLAR PROJECT

- Key**
- Order Limits
 - Sheet Index
 - Scheduled Monument
 - County Boundary

Note:
 Full details of the Historic Environmental Record (HER) sites and monuments depicted can be found in the gazetteers within the Desk Based Assessment (DBA) which are included in Appendix 13.1 of the Environmental Statement (ES), and the designated assets on Historic England's National Heritage List for England are discussed in detail in the Heritage Statement included in Appendix 13.5 of the ES

Layers: Historic England, 2016; Nottinghamshire County Council, 2024; Lincolnshire County Council, 2024; Lanpro, 2024; GP, 2024
 Base map: Reproduced from Ordnance Survey digital map data © Crown copyright 2024. All rights reserved. License number 0100031673

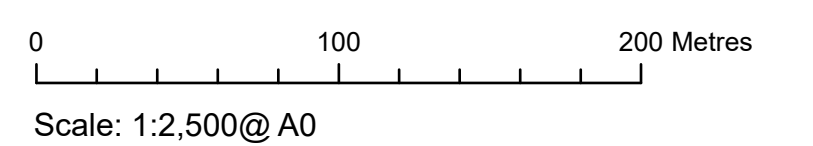

APFP Regulation: 5(2)(m)	Application Doc No. EX4/WB2.8_A
Ref: P2963_LPR_ZZ_ON_DR_Z_0204	Date: 28/02/2024
Drawn by: AZ	Checked by: JC

**Plan of Statutory and Non-statutory
 Features of Historic Environment**
 Sheet 3 of 10
 Revision A

WEST BURTON SOLAR PROJECT

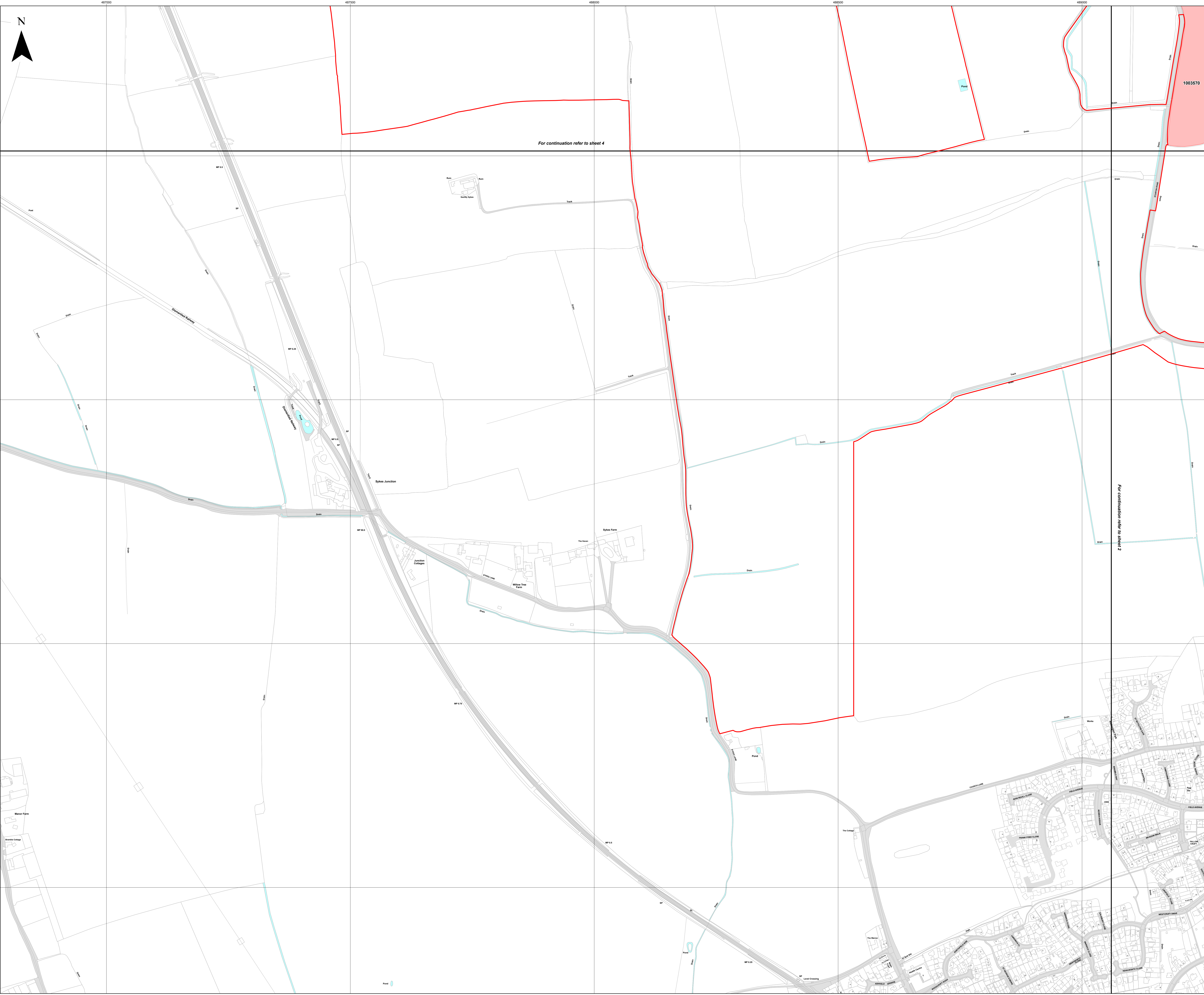

Key

- Order Limits
- Sheet Index
- Listed Building
- Grade
- II
- Scheduled Monument
- County Boundary

Note:
Full details of the Historic Environmental Record (HER) sites and monuments depicted can be found in the gazetteers within the Desk Based Assessment (DBA) which are included in Appendix 13.1 of the Environmental Statement (ES), and the designated assets on Historic England's National Heritage List for England are discussed in detail in the Heritage Statement included in Appendix 13.5 of the ES

Layers: Historic England, 2016; Nottinghamshire County Council, 2024; Lincolnshire County Council, 2024; Lanpro, 2024; GP, 2024
Base map: Reproduced from Ordnance Survey digital map data © Crown copyright 2024. All rights reserved. License number 0100031673

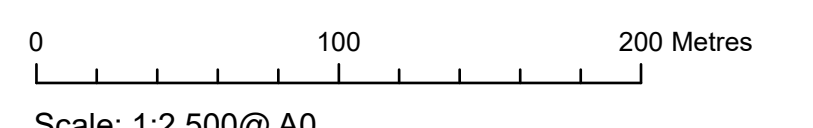

APFP Regulation: 5(2)(m)	Application Doc No. EX4/WB2.8_A
Ref: P2963_LPR_ZZ_ON_DR_Z_0204	Date: 28/02/2024
Drawn by: AZ	Checked by: JC

**Plan of Statutory and Non-statutory
Features of Historic Environment**
Sheet 4 of 10
Revision A

WEST BURTON SOLAR PROJECT

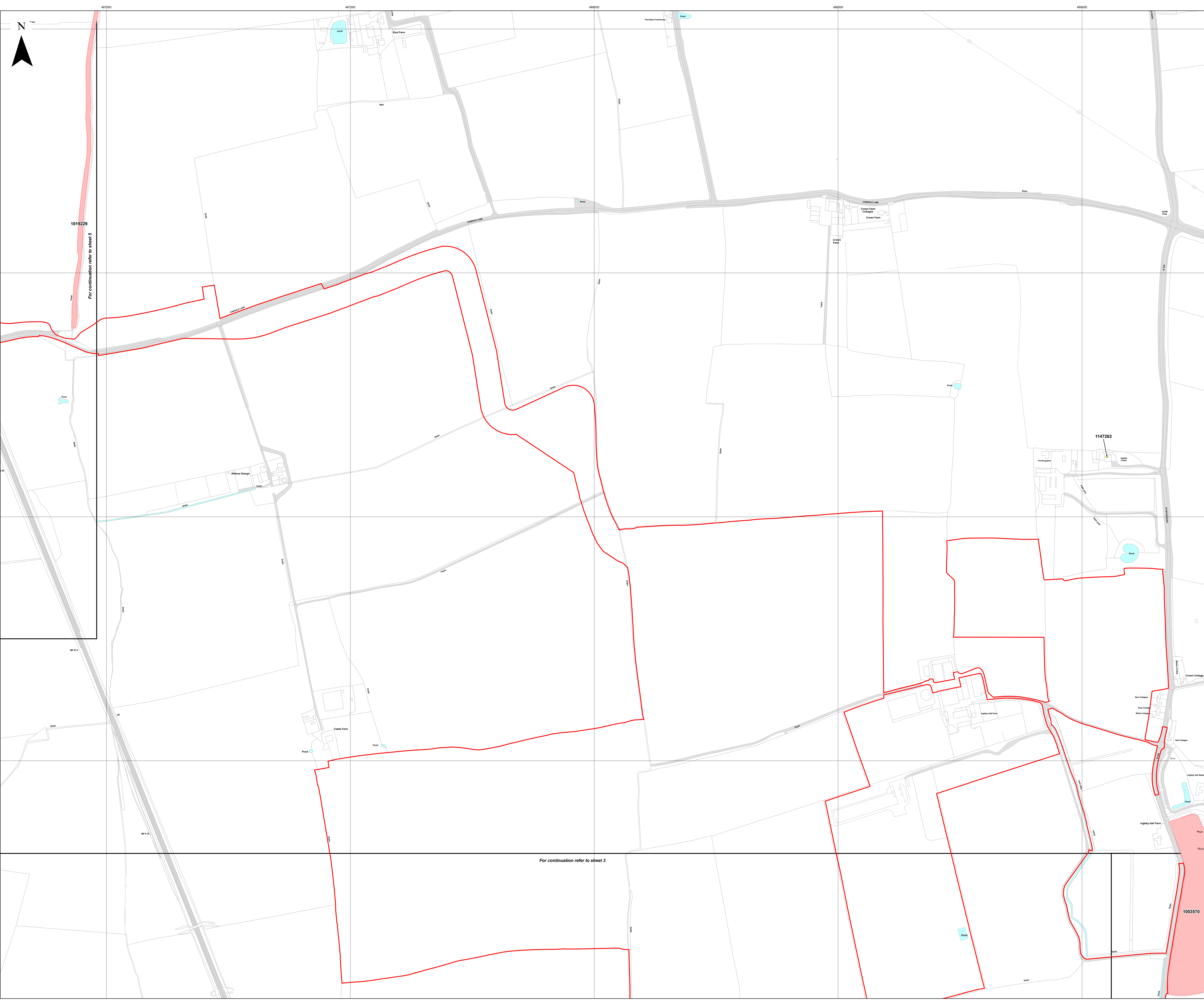

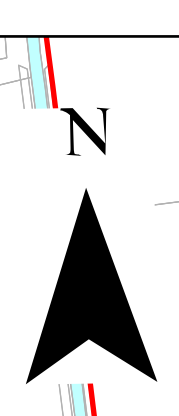
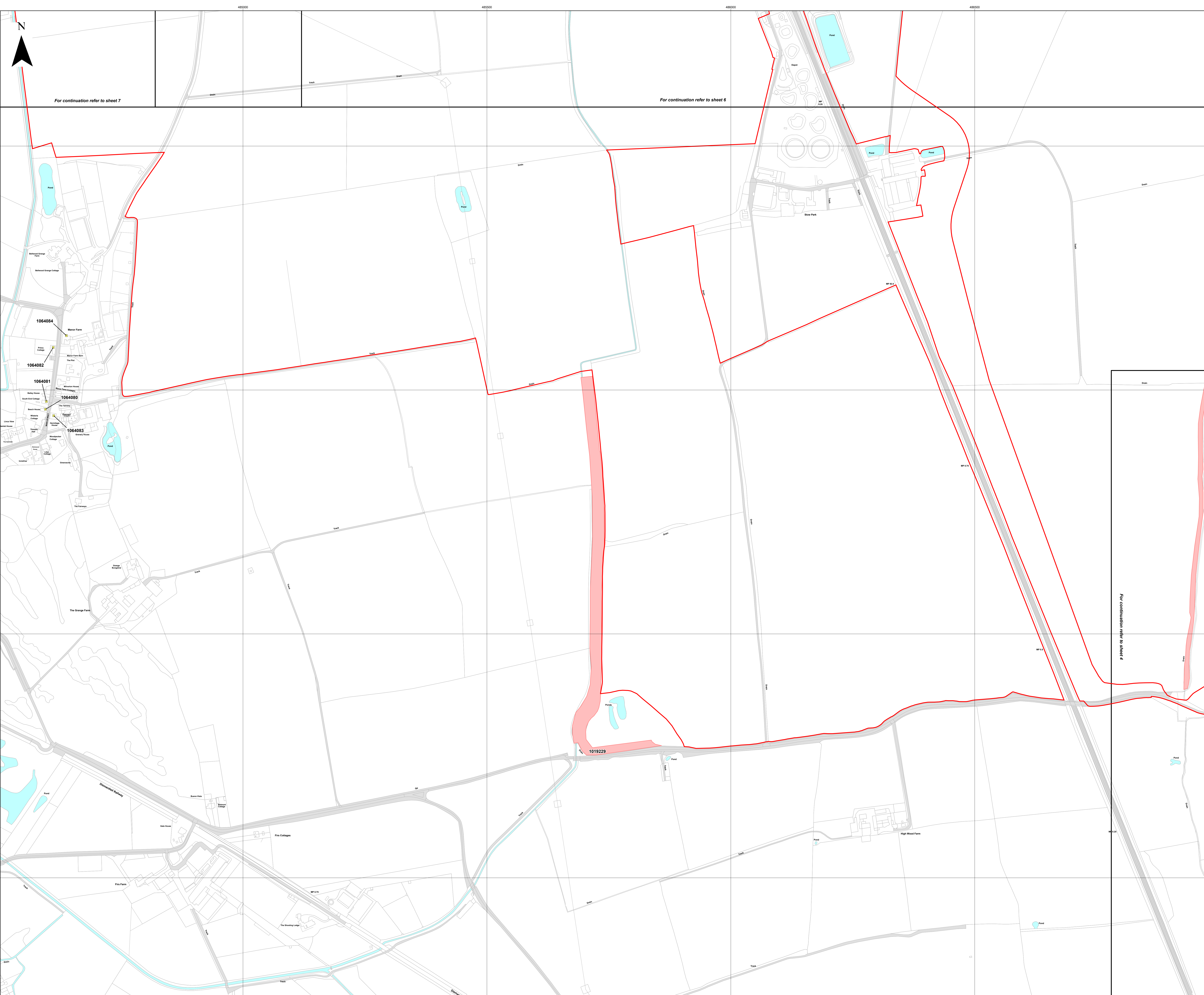

For continuation refer to sheet 7

For continuation refer to sheet 6

For continuation refer to sheet 4

Key

- Order Limits
- Sheet Index
- Listed Building
- Grade**
- II
- Scheduled Monument
- County Boundary

Note:
Full details of the Historic Environmental Record (HER) sites and monuments depicted can be found in the gazetteers within the Desk Based Assessment (DBA) which are included in Appendix 13.1 of the Environmental Statement (ES), and the designated assets on Historic England's National Heritage List for England are discussed in detail in the Heritage Statement included in Appendix 13.5 of the ES

Layers: Historic England, 2016; Nottinghamshire County Council, 2024; Lincolnshire County Council, 2024; Lanpro, 2024; GP, 2024
Base map: Reproduced from Ordnance Survey digital map data © Crown copyright 2024. All rights reserved. License number 0100031673

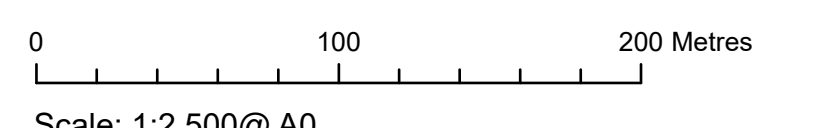

Scale: 1:2,500@ A0

APFP Regulation: 5(2)(m)	Application Doc No. EX4/WB2.8_A
Ref: P2963_LPR_ZZ_ON_DR_Z_0204	Date: 28/02/2024
Drawn by: AZ	Checked by: JC

**Plan of Statutory and Non-statutory
Features of Historic Environment**
Sheet 5 of 10
Revision A

WEST BURTON SOLAR PROJECT

Key

- Order Limits
- Sheet Index
- Listed Building
- Grade**
- II
- Scheduled Monument
- Lincolnshire HER (Line)
- Monument
- County Boundary

Note:
Full details of the Historic Environmental Record (HER) sites and monuments depicted can be found in the gazetteers within the Desk Based Assessment (DBA) which are included in Appendix 13.1 of the Environmental Statement (ES), and the designated assets on Historic England's National Heritage List for England are discussed in detail in the Heritage Statement included in Appendix 13.5 of the ES

Layers: Historic England, 2024; Nottinghamshire County Council, 2024; Lincolnshire County Council, 2024; Lanpro, 2024; GP, 2024
Base map: Reproduced from Ordnance Survey digital map data © Crown copyright 2024. All rights reserved. License number 0100031673

0 100 200 Metres

Scale: 1:2,500@A0

APFP Regulation: 5(2)(m)	Application Doc No. EX4/WB2.8_A
Ref: P2963_LPR_ZZ_ON_DR_Z_0204	Date: 28/02/2024
Drawn by: AZ	Checked by: JC

**Plan of Statutory and Non-statutory
Features of Historic Environment**
Sheet 6 of 10
Revision A

WEST BURTON SOLAR PROJECT

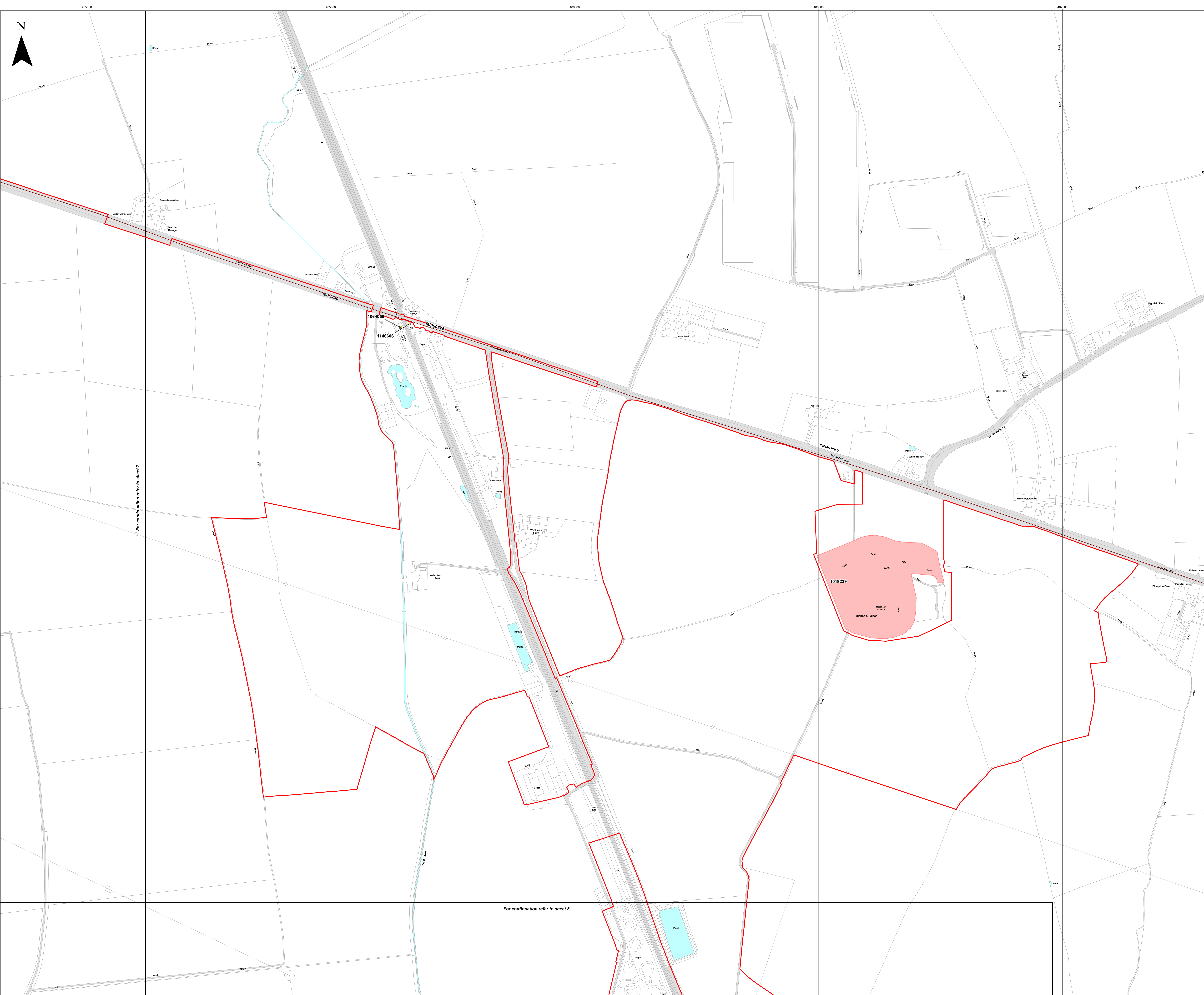

For continuation refer to sheet 7

For continuation refer to sheet 5

- Key**
- Order Limits
 - Sheet Index
 - Listed Building
 - Grade
 - I
 - II
 - Scheduled Monument
 - Lincolnshire HER (point)
 - Find Spot
 - Lincolnshire HER (Line)
 - Monument
 - Lincolnshire HER (poly)
 - Building
 - Monument
 - Nottinghamshire HER (point)
 - Building
 - Element
 - County Boundary

Note:
Full details of the Historic Environmental Record (HER) sites and monuments depicted can be found in the gazetteers within the Desk Based Assessment (DBA) which are included in Appendix 13.1 of the Environmental Statement (ES), and the designated assets on Historic England's National Heritage List for England are discussed in detail in the Heritage Statement included in Appendix 13.5 of the ES

Layers: Historic England, 2016; Nottinghamshire County Council, 2016; Lincolnshire County Council, 2016; Lanpro, 2024; GP, 2024
Base map: Reproduced from Ordnance Survey digital map data © Crown copyright 2024. All rights reserved. License number 0100031673

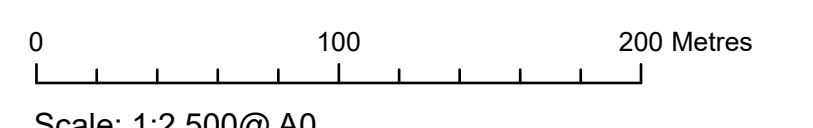

APFP Regulation: 5(2)(m)	Application Doc No. EX4/WB2.8_A
Ref: P2963_LPR_ZZ_ON_DR_Z_0204	Date: 28/02/2024
Drawn by: AZ	Checked by: JC

**Plan of Statutory and Non-statutory
Features of Historic Environment**
Sheet 7 of 10
Revision A

WEST BURTON SOLAR PROJECT

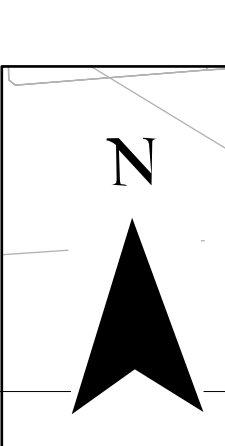
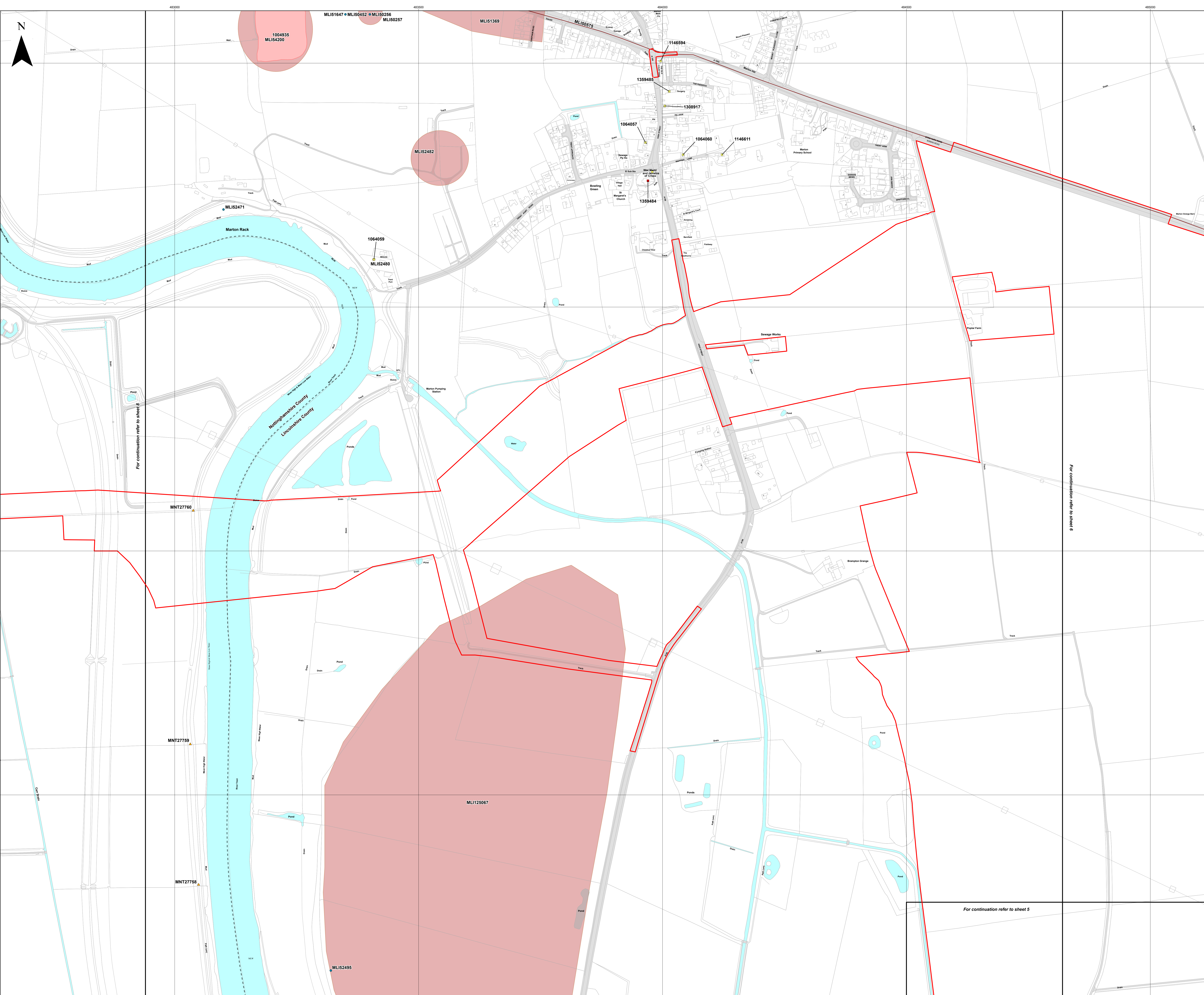

For continuation refer to sheet 8

For continuation refer to sheet 6

For continuation refer to sheet 5

Key

- Order Limits
- Sheet Index
- Nottinghamshire HER (point)**
- ▲ Building
- ▲ Element
- ▲ Monument
- Nottinghamshire (poly)**
- Element
- Monument
- County Boundary

Note:
Full details of the Historic Environmental Record (HER) sites and monuments depicted can be found in the gazetteers within the Desk Based Assessment (DBA) which are included in Appendix 13.1 of the Environmental Statement (ES), and the designated assets on Historic England's National Heritage List for England are discussed in detail in the Heritage Statement included in Appendix 13.5 of the ES

Layers: Historic England, 2024; Nottinghamshire County Council, 2024; Lincolnshire County Council, 2024; Lanpro, 2024; GP, 2024
Base map: Reproduced from Ordnance Survey digital map data © Crown copyright 2024. All rights reserved. License number 0100031673

0 100 200 Metres
Scale: 1:2,500@A0

APFP Regulation: 5(2)(m)	Application Doc No. EX4/WB2.8_A
Ref: P2963_LPR_ZZ_ON_DR_Z_0204	Date: 28/02/2024
Drawn by: AZ	Checked by: JC

**Plan of Statutory and Non-statutory
Features of Historic Environment**
Sheet 8 of 10
Revision A

WEST BURTON SOLAR PROJECT

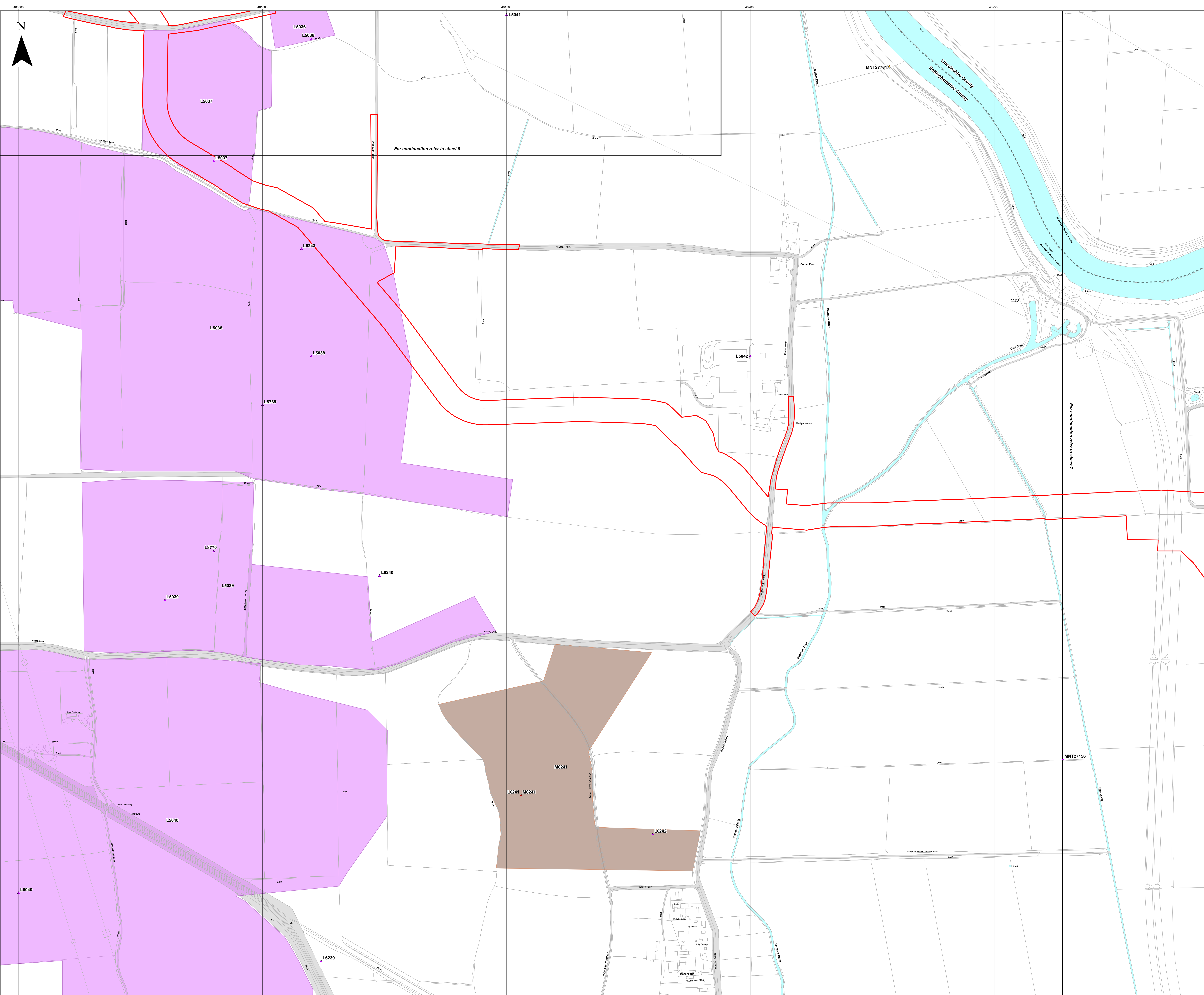

For continuation refer to sheet 9

For continuation refer to sheet 7

Key

- Order Limits
- Sheet Index
- Listed Building
- Grade
- II
- Nottinghamshire HER (point)
- ▲ Element
- ▲ Monument
- Nottinghamshire (poly)
- Building
- Element
- - - County Boundary

Note:
Full details of the Historic Environmental Record (HER) sites and monuments depicted can be found in the gazetteers within the Desk Based Assessment (DBA) which are included in Appendix 13.1 of the Environmental Statement (ES), and the designated assets on Historic England's National Heritage List for England are discussed in detail in the Heritage Statement included in Appendix 13.5 of the ES

Layers: Historic England, 2016; Nottinghamshire County Council, 2024; Lincolnshire County Council, 2024; Lanpro, 2024; GP, 2024
Base map: Reproduced from Ordnance Survey digital map data © Crown copyright 2024. All rights reserved. License number 0100031673

0 100 200 Metres
Scale: 1:2,500@A0

APFP Regulation: 5(2)(m)	Application Doc No. EX4/WB2.8_A
Ref: P2983_LPR_ZZ_ON_DR_Z_0204	Date: 28/02/2024
Drawn by: AZ	Checked by: JC

**Plan of Statutory and Non-statutory
Features of Historic Environment**
Sheet 9 of 10
Revision A

WEST BURTON SOLAR PROJECT

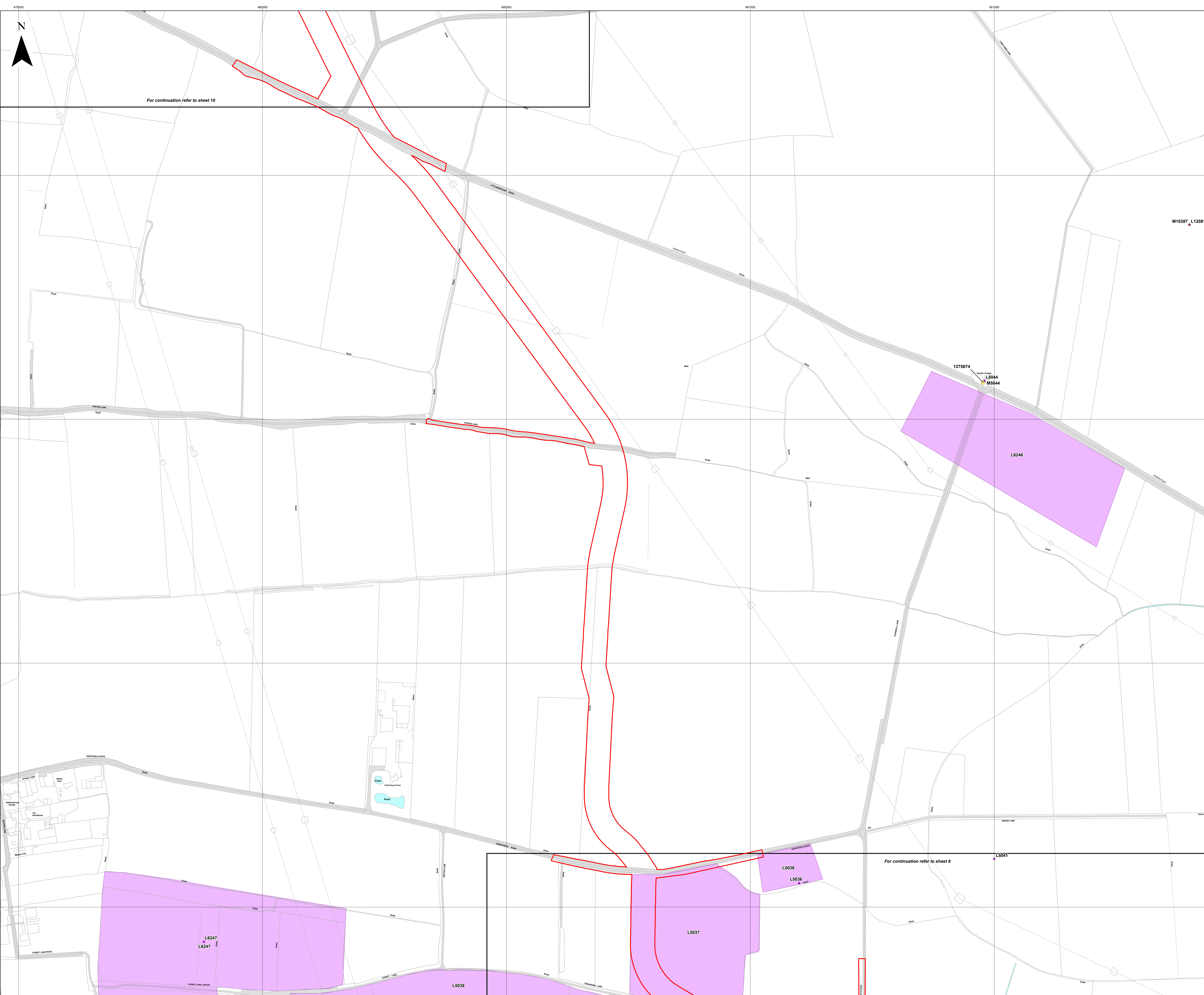

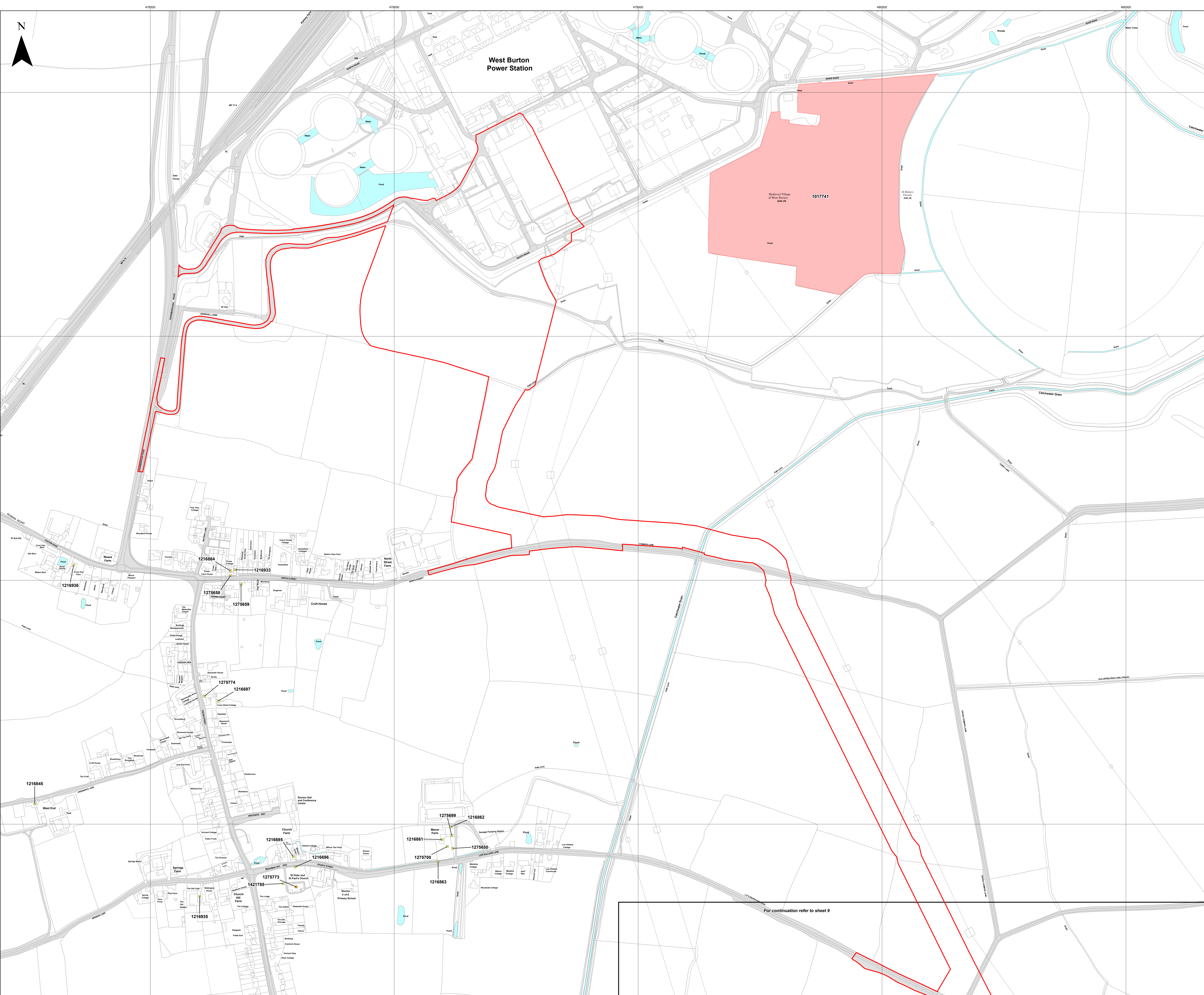

Key

- Order Limits
- Sheet Index
- Listed Building
- Grade
- II*
- II
- Scheduled Monument
- County Boundary

Note:
Full details of the Historic Environmental Record (HER) sites and monuments depicted can be found in the gazetteers within the Desk Based Assessment (DBA) which are included in Appendix 13.1 of the Environmental Statement (ES), and the designated assets on Historic England's National Heritage List for England are discussed in detail in the Heritage Statement included in Appendix 13.5 of the ES

Layers: Historic England, 2016; Nottinghamshire County Council, 2024; Lincolnshire County Council, 2024; Lanpro, 2024; GP, 2024
Base map: Reproduced from Ordnance Survey digital map data © Crown copyright 2024. All rights reserved. License number 0100031673

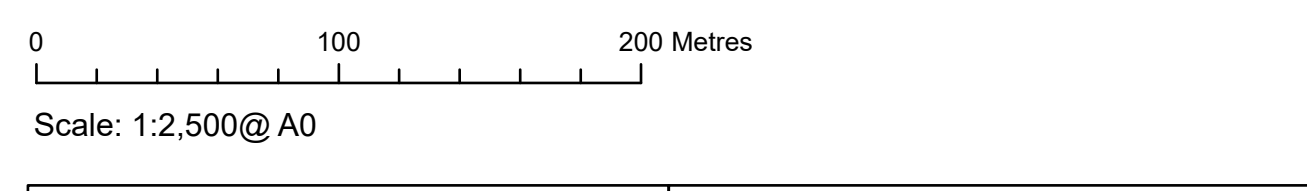

APFP Regulation: 5(2)(m)	Application Doc No. EX4/WB2.8_A
Ref: P2983_LPR_ZZ_ON_DR_Z_0204	Date: 28/02/2024
Drawn by: AZ	Checked by: JC

**Plan of Statutory and Non-statutory
Features of Historic Environment**
Sheet 10 of 10
Revision A

WEST BURTON SOLAR PROJECT

For continuation refer to sheet 9